

DESCRIPTION	RUNWAY 5-23		RUNWAY 14-32		RUNWAY 18-36	
	EXISTING	FUTURE	EXISTING	FUTURE	EXISTING	FUTURE
AIRPORT REFERENCE CODE	C-II	C-III	B-I	B-II	N/A	A/B-I
TYPICAL "CRITICAL" AIRCRAFT TYPE	GULF STREAM III	SAME	CITATION I	CITATION II KINGAIR 200	N/A	CESSNA 172
RUNWAY DIMENSIONS	6,670' x 150'	6,670' x 100'	4,400' x 100'	4,400' x 100'	N/A	2,400' x 120'
PAVEMENT TYPE	CONCRETE	CONCRETE	ASPHALT	ASPHALT	N/A	TURF
PAVEMENT STRENGTH	46,000 LBS.	46,000 LBS.	38,000 LBS.	38,000 LBS.	N/A	20,000 LBS.
STRENGTH DUAL WHEEL GEAR	60,000 LBS.	60,000 LBS.	N/A	N/A	N/A	N/A
EFFECTIVE GRADIENT (%)	0.01	0.01	0.20	0.20	N/A	0.20
APPROACH SLOPE	34:1	34:1	20:1	20:1	N/A	20:1
RUNWAY LIGHTING	MIRL	MIRL	NONE	MIRL	N/A	NONE
RUNWAY MARKING	NON-PRECISION	NON-PRECISION	BASIC	BASIC	N/A	NONE
TAXIWAY LIGHTING	NONE	MIL	NONE	MIL	N/A	N/A
TAXIWAY MARKING	NONE	CENTERLINE	NONE	CENTERLINE	N/A	N/A
NAVIGATIONAL AIDS	REILS, PAPI-2	REILS, PAPI-2	NONE	REILS, PAPI-2	N/A	NONE
APPROACH VISIBILITY MINIMUMS	GPS: 1 MILE	GPS: 1 MILE	N/A	N/A	N/A	N/A
DISTANCE BETWEEN TWY C AND RWY G	400'	400'	N/A	N/A	N/A	N/A
TAXIWAY "A" WIDTH	300'	400'	N/A	300'	N/A	150'
MAX ELEV. ABOVE MSL	75.6'	50'	35'	74.1'	64.6'	25'
PART 77 APPROACH CAT.	NON-PRECISION	NON-PRECISION	VISUAL	VISUAL	N/A	VISUAL
ROFA DIM (W x L)	800' x 1000'	800' x 1000'	400' x 240'	500' x 300'	N/A	400' x 240'

AIRPORT DATA		
DESCRIPTION	EXISTING	FUTURE
AIRPORT REFERENCE CODE	C-II	C-III
AIRPORT REFERENCE POINT (ARP)	29°12'11" N 82°8'13" W	29°11'17" N 82°8'13" W
MAX. MEAN TEMP. OF HOTTEST MONTH	91.5°	91.5°
AIRPORT ELEVATION	76.2 MSL	76.2 MSL
AIRPORT AND TERMINAL NAVIGATIONAL AIDS	ROTATING BEACON AWOS	ROTATING BEACON AWOS
	GPS TO 5-23, REMOTE VOR-23	GPS TO 5-23, REMOTE VOR-23

NAD 83 COORDINATES & ELEVATIONS			
LOCATION	LATITUDE	LONGITUDE	ELEVATION
(A) THRESHOLD & END R/W 23	29°21'56.03"N	82°27'42.43"W	75.56'
(B) THRESHOLD & END R/W 5	29°21'09.28"N	82°28'35.63"W	72.98'
(C) END R/W 14	29°21'20.82"N	82°28'50.67"W	66.56'
(D) THRESHOLD R/W 14	29°21'18.60"N	82°28'48.42"W	68.82'
(E) END R/W 32	29°20'43.76"N	82°28'13.22"W	63.80'
(F) THRESHOLD R/W 32	29°20'45.99"N	82°28'15.47"W	63.95'
(G) THRESHOLD & END R/W 36	29°21'11.09"N	82°27'47.44"W	64.64'
(H) THRESHOLD & END R/W 18	29°20'47.33"N	82°27'47.43"W	62.85'

EXISTING FACILITIES / UTILITIES	
(1)	AIRCRAFT PARKING APRON
(2)	INDIVIDUAL HANGARS
(3)	TAXIWAY A EXTENSION
(4)	STORAGE AND MAINTENANCE HANGAR / FBO
(5)	SHERIFFS HANGAR
(6)	QUONSET HUT
(7)	INDIVIDUAL HANGAR
(8)	MANUFACTURING / OFFICE BUILDINGS
(9)	12,000 GAL. FUEL TANK
(10)	SEGMENTED CIRCLE
(11)	AIRPORT ROTATING BEACON
(12)	CONVENTIONAL HANGAR
(13)	RUNWAY END IDENTIFIER LIGHTS
(14)	RAILROAD
(15)	AWOS

FUTURE FACILITIES / UTILITIES	
(20)	TERMINAL AUTOMOBILE PARKING
(21)	GA TERMINAL BUILDING
(22)	T-HANGAR
(23)	CORPORATE HANGARS (4 UNIT BUILDINGS)
(24)	CORPORATE INDIVIDUAL HANGAR
(25)	SMALL INDIVIDUAL HANGAR
(26)	HANGAR ACCESS & PARKING
(27)	TAXIWAY G
(28)	TURF 2400
(29)	RAILROAD SPUR
(30)	TAXIWAY F EXTENSION
(31)	CORPORATE HANGAR
(32)	FBO/MAINTENANCE HANGAR
(33)	TERMINAL APRON
(34)	TAXILANE
(35)	TERMINAL ACCESS ROAD
(36)	FUEL FARM (1-12,000 JET A, 1-12,000 AvGAS)
(37)	INDUSTRIAL PARK ROAD
(38)	INDUSTRIAL PARK DEVELOPMENT
(39)	FBO UPGRADES
(40)	TRANSIENT APRON
(41)	NEW TAXIWAY H
(42)	APRON EXTENSION

RUNWAY SAFETY AREA DIMENSIONS		
	EXISTING	FUTURE
RWY. 5 (150' X 300')		RWY. 5 (150' X 300')
RWY. 23 (150' X 300')		RWY. 23 (300' X 600')
RWY. 14 (150' X 300')		RWY. 14 (150' X 300')
RWY. 32 (150' X 300')		RWY. 32 (150' X 300')

FAA AIRPORT DESIGN STANDARD DEVIATIONS				
DEVIATION DESCRIPTION	DESIGN STANDARD	STANDARD	EXISTING	DISPOSITION
NONE				

REVISION TABLE		
REVISION	DESCRIPTION	DATE
▲	FDOT TEST TRACK, WITH EASEMENT.	November, 2013
▲	TIDEWATER TRUCKING ADDITION	January, 2014
▲	APRON EXTENSION / CORPORATE HANGARS	January, 2014
▲	CORPORATE HANGAR TO BE USED BY FDOT	January, 2014
▲	FUTURE TURF RUNWAY DECOMMISSIONED	January, 2014

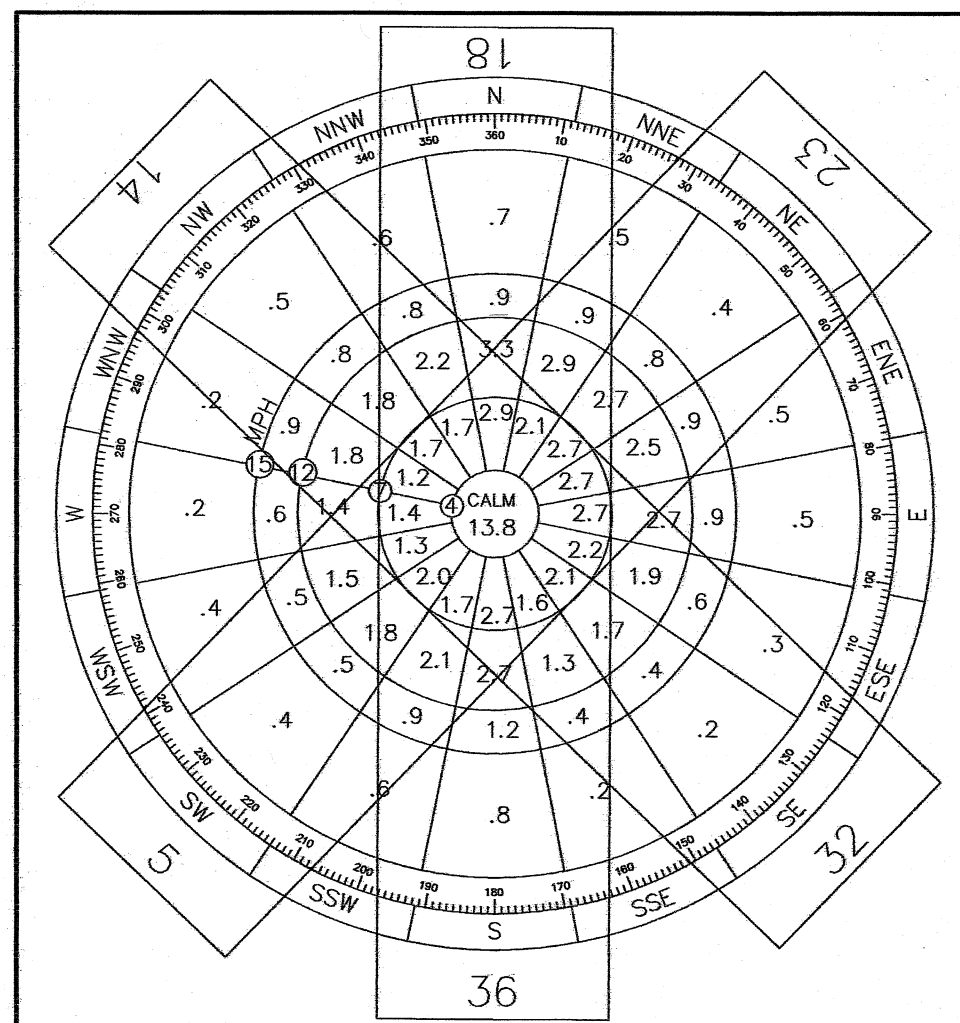

ALL WEATHER WINDROSE

	12 MPH	15 MPH
RUNWAY 5-23	93.4%	96.9%
RUNWAY 14-32	92.6%	-
RUNWAY 18-36	89.7%	-
COMBINED	98.6%	-

SOURCE: U.S. WEATHER BUREAU, ORLANDO AND JACKSONVILLE, FLORIDA

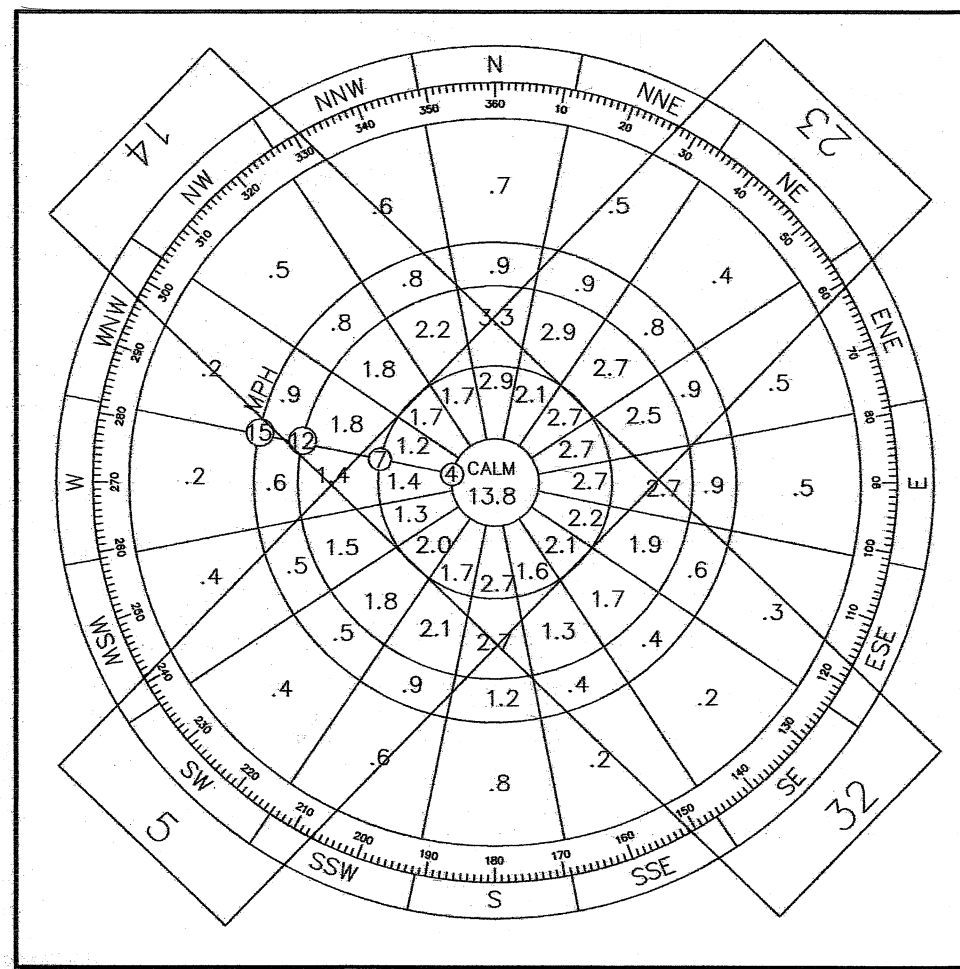

IFR WINDROSE

	12 MPH	15 MPH
RUNWAY 5-23	93.4%	96.9%
RUNWAY 14-32	92.6%	-
COMBINED	98.6%	-

SOURCE: U.S. WEATHER BUREAU, ORLANDO AND JACKSONVILLE, FLORIDA

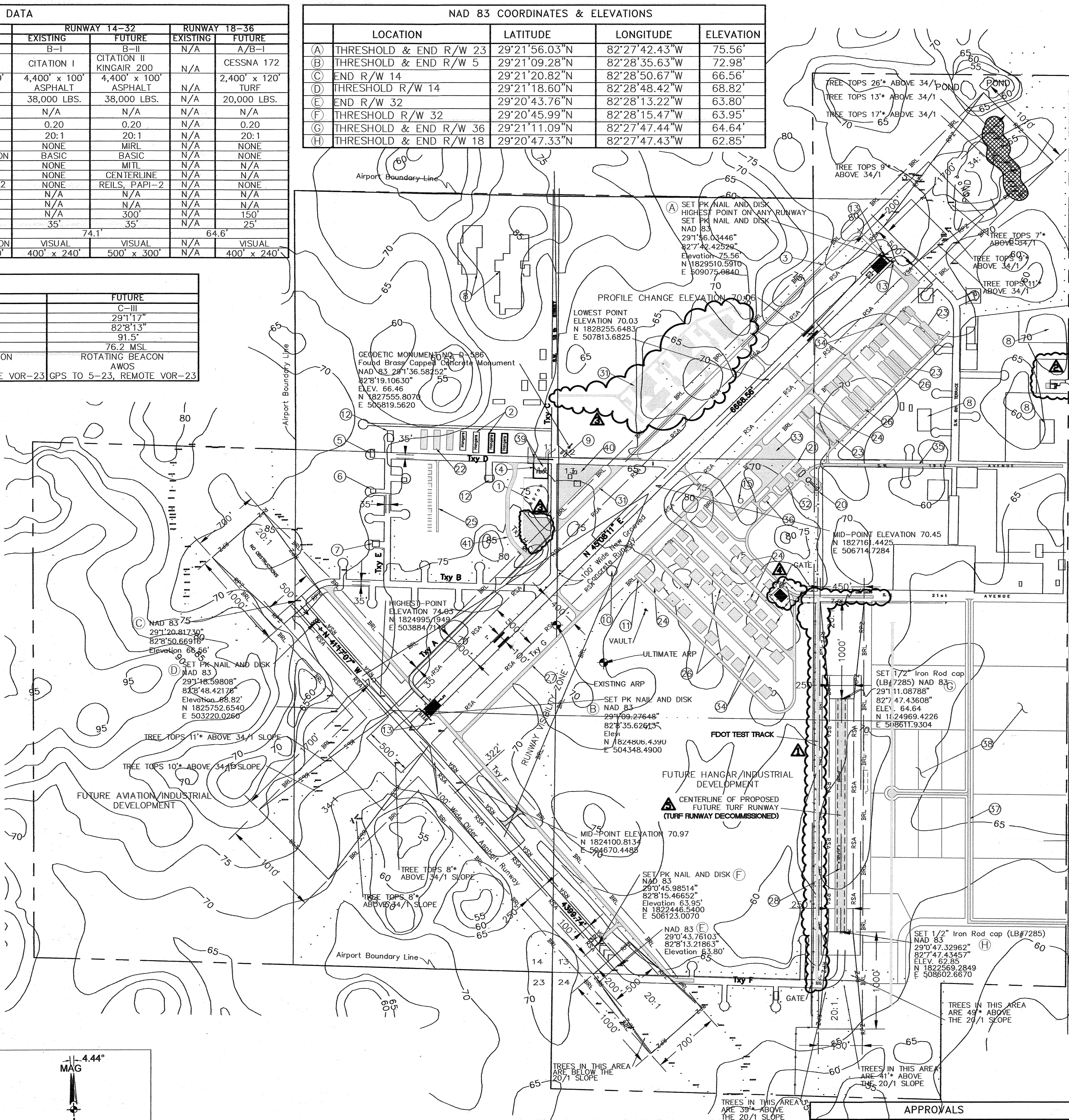

DESCRIPTION	RUNWAY PROTECTION ZONE DIMENSIONS											
	RUNWAY 5-23				RUNWAY 14-32				RUNWAY 18-36			
	EXISTING	FUTURE	EXISTING	FUTURE	EXISTING	FUTURE	EXISTING	FUTURE				
INNER WIDTH	500'	500'	500'	500'	500'	500'	500'	500'	N/A	N/A	250'	250'
OUTER WIDTH	1010'	1010'	1010'	1010'	700'	700'	700'	700'	700'	700'	450'	450'
LENGTH	1700'	1700'	1700'	1700'	1000'	1000'	1000'	1000'			1000'	1000'

APPROVALS

CITY OF WILLISTON _____ DATE _____

FLA. DEPT. OF TRANS. _____ DATE _____

FEDERAL AVIATION ADMINISTRATION _____ DATE _____

LEGEND		
EXISTING	FUTURE	STRUCTURE
[Symbol]	[Symbol]	EDGE OF PAVEMENT
[Symbol]	[Symbol]	CENTERLINE
[Symbol]	[Symbol]	CONTOUR
[Symbol]	[Symbol]	TREELINE
[Symbol]	[Symbol]	RUNWAY MARKINGS
[Symbol]	[Symbol]	FENCE
[Symbol]	[Symbol]	PROPERTY LINE
[Symbol]	[Symbol]	AIRPORT REFERENCE POINT (ARP)
[Symbol]	[Symbol]	BUILDING RESTRICTION LINE
[Symbol]	[Symbol]	RUNWAY OBJECT FREE AREA
[Symbol]	[Symbol]	RUNWAY PROTECTION ZONE
[Symbol]	[Symbol]	RUNWAY SAFETY AREA
[Symbol]	[Symbol]	RUNWAY VISIBILITY ZONE
[Symbol]	[Symbol]	TAXIWAY OBJECT FREE AREA
[Symbol]	[Symbol]	TAXIWAY SAFETY AREA
[Symbol]	[Symbol]	RUNWAY END IDENTIFICATION LIGHTS
[Symbol]	[Symbol]	RUNWAY THRESHOLD LIGHTS
[Symbol]	[Symbol]	PRECISION APPROACH PATH INDICATOR
[Symbol]	[Symbol]	AIRPORT ROTATING BEACON

AIRPORT LAYOUT PLAN